

# Small Hexagonal Posts

## Both Ends Tapped / One End Threaded, One End Tapped

Features: Suitable when space is limited.

Small Hexagonal Posts –  
Both Ends Tapped / One End  
Threaded, One End Tapped



RoHS10

Type		Material	Surface Treatment
Both Ends Tapped	One End Threaded, One End Tapped		
BSLCB	BSLCG	1018 Carbon Steel or Equivalent or SUM	Black Oxide
PSLCB	PSLCG		Electroless Nickel Plating
SLCB	SLCG	303 Stainless Steel	—

25/(6.3/1.6/)

Both Ends Tapped

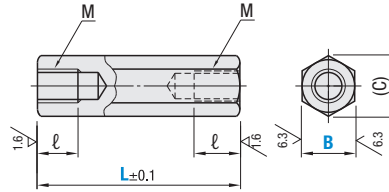

One End Threaded, One End Tapped

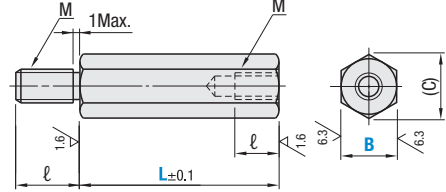

Part Number		B	L Dimension Selection																	M	ℓ	(C)
Both Ends Tapped	One End Threaded, One End Tapped		4	5	6	7	8	9	10	11	12	13	14	15	16	17	18	20				
BSLCB	BSLCG	4	5	6	7	8	9	10	15	20	M2	5	4.6									
PSLCB	PSLCG	5	5	6	8	9	10	15	20	M2.6	5	5.8										
SLCB	SLCG	5.5	5	6	7	8	9	10	11	12	13	14	15	16	17	18	20	M3	6	6.3		

- ① \*B Dimensions 4 and 5 are only applicable to SLCB and SLCG.
- ① Anti-rust Oil is applied to posts with black oxide and electroless nickel plating finish.
- ① When L≤Mx6, the Pilot Hole for Both Ends Tapped Type may go through.
- ① For One End Threaded and One End Tapped Type, when L dimensions is 5 and 6, then ℓ dimension is 3 and 4 respectively.

**Part Number Example**

Part Number	-	L
BSLCB 5.5	-	12
SLCG 5	-	20